



# USER INSTRUCTIONS

## **EAR-SETS**

FOR WIDEX HEARING AIDS



**WIDEX**<sup>®</sup>  
HIGH DEFINITION HEARING

## EAR-SETS FOR BTE HEARING AIDS

*(To be filled out by the hearing care professional)*

**Your ear-set type:**

INSTANT EAR-TIPS FOR RIC/RITE HEARING AIDS

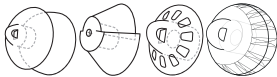

CUSTOM EAR-TIPS AND EARMOULDS FOR RIC/RITE HEARING AIDS



INSTANT EAR-TIPS FOR HEARING AIDS WITH THIN TUBE 0.9 AND 1.4

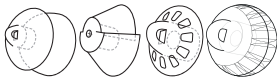

CUSTOM EAR-TIPS FOR HEARING AIDS WITH THIN TUBE 0.9 AND 1.4



INSTANT AND CUSTOM EAR-TIPS FOR HEARING AIDS WITH CLASSIC THIN TUBE

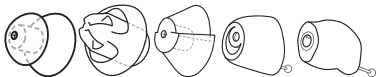

---

EARMOULDS FOR HEARING AIDS WITH CLASSIC TUBE



# CONTENTS

<b>INTRODUCTION TO YOUR EAR-SET.....</b>	<b>6</b>
Welcome.....	6
Mounting of receiver and Thin Tube to hearing aid.....	6
<b>INSTANT EAR-TIPS FOR RIC/RITE MODELS.....</b>	<b>7</b>
Cleaning tools.....	7
Cleaning.....	8
Using the wax guard.....	9
Changing the ear-tip.....	11
Using an anchor.....	12
<b>CUSTOM EAR-TIPS AND EARMOULDS FOR RIC/RITE MODELS.....</b>	<b>13</b>
Cleaning tools.....	14
Cleaning.....	14
Using the wax guard.....	15
<b>INSTANT EAR-TIPS FOR THIN TUBE 0.9 AND 1.4.....</b>	<b>18</b>
Cleaning tools.....	18
Cleaning.....	19
Using the wax guard.....	20
Changing the ear-tip.....	22
Changing the Thin Tube.....	22
Using an anchor.....	25

<b>CUSTOM EAR-TIPS FOR THIN TUBE 0.9 AND 1.4.....</b>	<b>26</b>
Cleaning tools.....	26
Cleaning.....	27
Using the wax guard.....	28
<b>INSTANT AND CUSTOM EAR-TIPS FOR CLASSIC THIN TUBE.....</b>	<b>31</b>
Cleaning tools.....	31
Cleaning .....	32
Changing the ear-tip.....	33
Changing the thin tube.....	35
Using an anchor.....	35
<b>CLASSIC EARMOULDS.....</b>	<b>38</b>
Cleaning tools.....	38
Cleaning.....	38
Changing the tube.....	40
<b>SYMBOLS.....</b>	<b>41</b>

# INTRODUCTION TO YOUR EAR-SET

## Welcome

This ear-set manual introduces you to the use of your ear-set. We advise you to read the chapter relating to your specific ear-set thoroughly, to learn about cleaning and changing parts.

### NOTE

The ear-sets and specific parts of the ear-sets may not look exactly as illustrated. We also reserve the right to make any changes considered necessary.

## Mounting of receiver and Thin Tube to hearing aid

It applies to all ear-sets that the receiver/Thin Tube must be mounted correctly to the hearing aid.

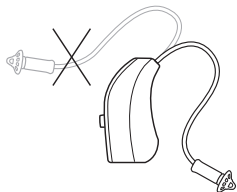

### Correct mounting

The receiver/Thin Tube must arch away from the hearing aid.

### Wrong mounting

The receiver/Thin Tube must not arch over the hearing aid.

## INSTANT EAR-TIPS FOR RIC/RITE MODELS

This chapter describes how to clean and handle various instant ear-tips for RIC/RITE models. The illustrations show a hearing aid with an open ear-tip, but the procedure is identical for the other instant ear-tips.



### Cleaning tools

You will receive the following cleaning tools with your hearing aid:

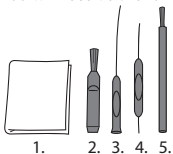

1. Cloth
2. Brush
3. Long wax-removing tool
4. Short wax-removing tool
5. Battery magnet

## Cleaning



Make sure that the ear-set is always clean and free of earwax, moisture or similar. Clean the earwire with the cloth after use.

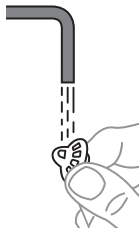

You can wash the instant ear-tip in lukewarm water **after having disconnected it from the rest of the ear-set**. Allow it to dry overnight.



Do not use any kind of liquid or disinfectant to clean your ear-set.



The receiver must **never** come into contact with water, as this may damage it.

For instructions on how to change the wax guard, see the wax guard section.



## Using the wax guard

The wax guard helps to protect the hearing aid against earwax. Always use a Widex wax guard with your hearing aid.

Check on a regular basis that your wax guard has not become blocked with earwax, in the following way:

First remove the ear-tip from the earwire. If wax has accumulated in the wax guard, change the wax guard.



Open the wax guard case as illustrated.

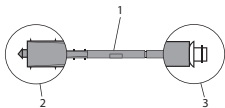

The wax guard consists of the following parts:

1. Holder
2. Removal hook
3. Wax guard

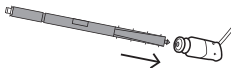

Insert the removal hook into the used wax guard.

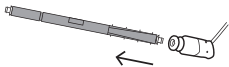

Pull the used wax guard straight out.



Turn the holder around.

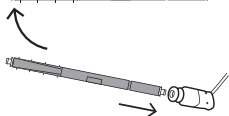

Insert the new wax guard into the opening of the sound outlet.

Pull the holder straight out. The new wax guard will automatically detach itself from the holder. Push the wax guard gently against a surface to ensure it stays in place. Push the ear-tip back into place.





The wax guard is for one-time use only and is not intended to be cleaned.



If the wax guard fits loosely, discard and use a new one.



If the wax guard falls off inside your ear, contact your doctor or hearing care professional to have it removed. Do NOT attempt to remove the wax guard yourself.

## Changing the ear-tip

You should change the ear-tip as required. For further supplies of ear-tips, or if the ear-tip no longer fits your ear, contact your hearing care professional.

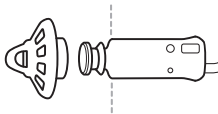

Push the new ear-tip onto the receiver until it reaches the point indicated by the dotted line.

When pushing the receiver into the ear-tip, you should feel it click into place.

### NOTE

It is very important to ensure that the ear-tip is firmly secured.



Do not attempt to disconnect the earwire from the hearing aid.

## Using an anchor

If you have an instant ear-tip solution, you can use an anchor to further ensure the comfortable retention of the ear-tip in your ear.

See below how to attach the anchor variant that you have received to your ear-set:

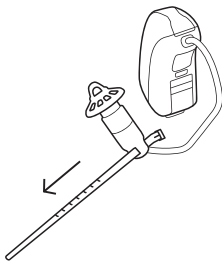

### **Anchor**

Pull the pointed end of the anchor through the hole on the side of the tubing.

Continue pulling until the anchor is stopped by the grip at the end.

Your ear-set is now ready to use.

Position it so that it rests comfortably in your ear.

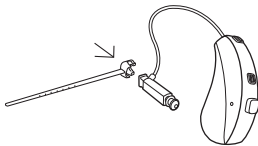

### **Anchor with lock**

Press the anchor lock towards the flat end of the receiver until it clicks.

Your ear-set is now ready to use.

Position it so that it rests comfortably in your ear.

## CUSTOM EAR-TIPS AND EARMOULDS FOR RIC/ RITE MODELS

This chapter describes how to clean and handle various custom ear-tips and earmoulds for RIC/RITE models. The illustrations show a hearing aid with an ear-tip, unless otherwise indicated.

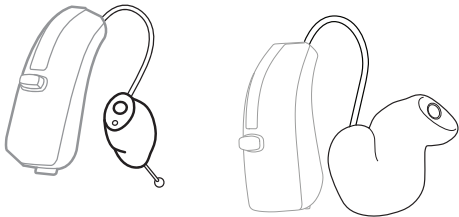

### NOTE

Always use the extraction cord to take the custom ear-tip out of your ear.

## Cleaning tools

You will receive the following cleaning tools with your hearing aid:

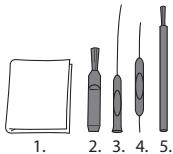

1. Cloth
2. Brush
3. Long wax-removing tool
4. Short wax-removing tool
5. Battery magnet

## Cleaning



Make sure that the ear-set is always clean and free of earwax, moisture or similar. Clean the earwire with the cloth after use.



Remove any visible earwax from around the sound outlet with the small brush or cloth. If the sound outlet is blocked, change the wax guard. Do NOT attempt to clean the wax guard.

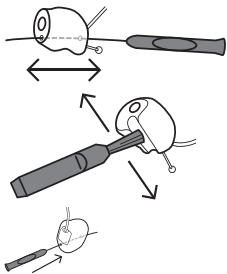

Your ear-tip/earmould may be provided with a vent. The illustrations to the left show how to clean the different types of vent.



The ear-set must never come into contact with liquids such as water or cleaning solutions.



Never attempt to disconnect the earwire from the custom ear-tip/earmould or the hearing aid, as this may damage the earwire.



Do not pull the earwire to remove the hearing aid from your ear.

## Using the wax guard

The wax guard helps to protect the hearing aid against earwax. Always use a Widex wax guard with your hearing aid.

Check on a regular basis that your wax guard has not become blocked with earwax.



Do NOT remove the custom ear-tip/earmould from the earwire.

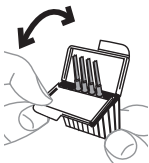

Open the wax guard case as illustrated.

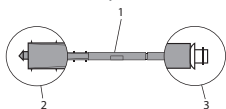

The wax guard consists of the following parts:

1. Holder
2. Removal hook
3. Wax guard

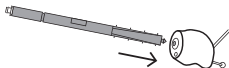

Insert the removal hook into the used wax guard.

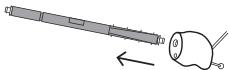

Pull the used wax guard straight out.

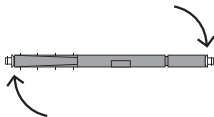

Turn the holder around.



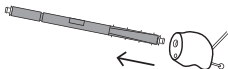

Insert the new wax guard into the opening of the sound outlet. Pull the holder straight out. The new wax guard will automatically detach itself from the holder. Press the wax guard gently against a flat surface to ensure that it stays in place.



The wax guard is for one-time use only and is not intended to be cleaned.



If the wax guard fits loosely, discard and use a new one.



If the wax guard falls off inside your ear, contact your doctor or hearing care professional to have it removed. Do NOT attempt to remove the wax guard yourself.

## INSTANT EAR-TIPS FOR THIN TUBE 0.9 AND 1.4

This chapter describes how to clean and handle the instant ear-tips for hearing aids with Thin Tube 0.9 and 1.4.



### Cleaning tools

You will receive the following cleaning tools with your hearing aid:

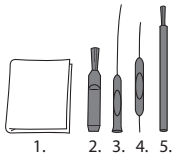

1. Cloth
2. Brush
3. Long wax-removing tool
4. Short wax-removing tool
5. Battery magnet

## Cleaning



Make sure that the ear-set is always clean and free of earwax, moisture or similar. Clean the tube with the cloth after use.

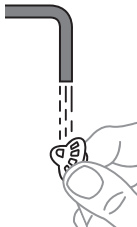

You can also wash the instant ear-tip in lukewarm water **after having disconnected it from the rest of the ear-set**. Allow it to dry overnight.



Do not use any kind of liquid or disinfectant to clean your ear-set.

For instructions on how to change the wax guard, see the wax guard section.

## Using the wax guard

The wax guard helps to protect the hearing aid against earwax. Always use a Widex wax guard with your hearing aid.

Check on a regular basis that your wax guard has not become blocked with earwax, in the following way:

First remove the ear-tip from the tube. If wax has accumulated in the wax guard, change it. Do NOT attempt to clean the wax guard.

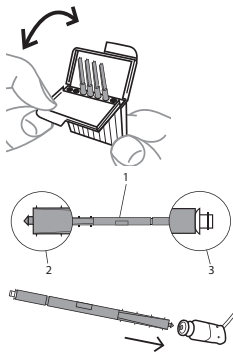

Open the wax guard case as illustrated.

The wax guard consists of the following parts:

1. Holder
2. Removal hook
3. Wax guard

Insert the removal hook into the used wax guard.

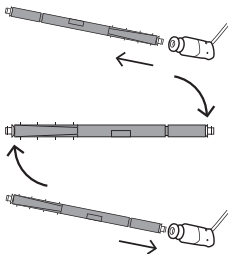

Pull the used wax guard straight out.

Turn the holder around.

Insert the new wax guard into the opening of the sound outlet. Pull the holder straight out. The new wax guard will automatically detach itself from the holder. Push the wax guard gently against a surface to ensure it stays in place. Push the ear-tip back into place.





The wax guard is for one-time use only and is not intended to be cleaned.



If the wax guard fits loosely, discard and use a new one.



If the wax guard falls off inside your ear, contact your doctor or hearing care professional to have it removed. Do NOT attempt to remove the wax guard yourself.

## Changing the ear-tip

You should change the ear-tip as required. For further supplies of ear-tips, or if the ear-tip no longer fits your ear, contact your hearing care professional.

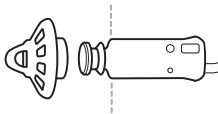

Push the new ear-tip onto the Thin Tube until it reaches the point indicated by the dotted line.

When pushing the end of the tube into the ear-tip, you should feel it click into place.

### NOTE

It is very important to ensure that the ear-tip is firmly secured.

## Changing the Thin Tube

Change the tube as required. For further supplies, contact your hearing care professional.

To remove the tube from the hearing aid, use the special tool you received with your Thin Tube.

**NOTE**

There are different tools available, and you should follow the instructions below for the special tool variant you have received.

**Wide tool variant**



1. Place the tube in the tool as shown in the illustration.

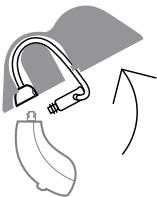

2. Lift the ear-set off the hearing aid at an angle as shown.

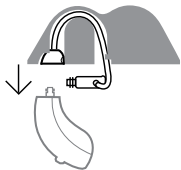

3. Then place the new tube in the tool and click it on the hearing aid.

### Narrow tool variant



1. Place the tube in the tool as shown in the illustration.



2. Press the tool downwards in an angle as shown.

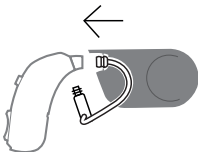

3. Place the new tube in the tool and click it on to the hearing aid.



## Using an anchor

You can use the anchor to further ensure the comfortable retention of the ear-tip in your ear.

See below how to attach the anchor variant that you have received to your ear-set:

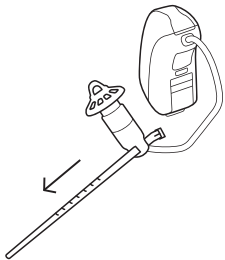

### **Anchor**

Pull the pointed end of the anchor through the hole on the side of the tubing.

Continue pulling until the anchor is stopped by the grip at the end.

Your ear-set is now ready to use.

Position it so that it rests comfortably in your ear.

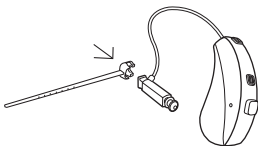

### **Anchor with lock**

Press the anchor lock towards the flat end of the receiver until it clicks.

Your ear-set is now ready to use.

Position it so that it rests comfortably in your ear.

## CUSTOM EAR-TIPS FOR THIN TUBE 0.9 AND 1.4

This chapter describes how to clean and handle the custom ear-tips for hearing aids with Thin Tube 0.9 and 1.4.

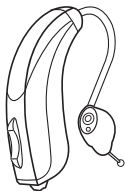

### NOTE

Always use the extraction cord to take the **custom ear-tip** out of your ear.

### Cleaning tools

You will receive the following cleaning tools with your hearing aid:

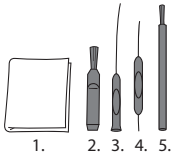

1. Cloth
2. Brush
3. Long wax-removing tool
4. Short wax-removing tool
5. Battery magnet

## Cleaning



Make sure that the ear-set is always clean and free of earwax, moisture or similar. Clean the tube with the cloth after use.

Remove any visible earwax from around the sound outlet with the small brush or cloth. If the sound outlet is blocked, change the wax guard. Do NOT attempt to clean the wax guard.

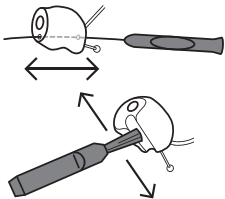

Your ear-tip may be provided with a vent. The illustrations below show how to clean the different types of vent.



The ear-set must never come into contact with liquids such as water or cleaning solutions.



Do not pull the tube to remove the hearing aid from your ear.

## Using the wax guard

The wax guard helps to protect the hearing aid against earwax. Always use a Widex wax guard with your hearing aid.

Check on a regular basis that your wax guard has not become blocked with earwax.



Do NOT remove the custom ear-tip from the tube.

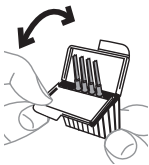

Open the wax guard case as illustrated.

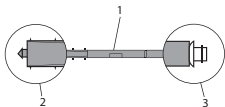

The wax guard consists of the following parts:

1. Holder
2. Removal hook
3. Wax guard

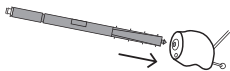

Insert the removal hook into the used wax guard.

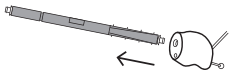

Pull the used wax guard straight out.



Turn the holder around.



Insert the new wax guard into the opening of the sound outlet. Pull the holder straight out. The new wax guard will automatically detach itself from the holder. Press the wax guard gently against a flat surface to ensure that it stays in place.

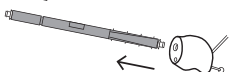



The wax guard is for one-time use only and is not intended to be cleaned.



If the wax guard fits loosely, discard and use a new one.



If the wax guard falls off inside your ear, contact your doctor or hearing care professional to have it removed. Do NOT attempt to remove the wax guard yourself.

## INSTANT AND CUSTOM EAR-TIPS FOR CLASSIC THIN TUBE

This chapter describes how to clean and handle various ear-tips for BTE models with classic thin tube.

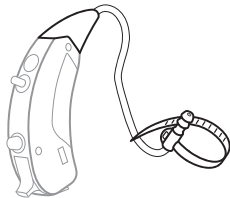

### Cleaning tools

You will receive the following cleaning tools with your hearing aid:

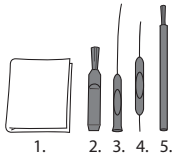

1. Cloth
2. Brush
3. Long wax-removing tool
4. Short wax-removing tool
5. Battery magnet

## Cleaning

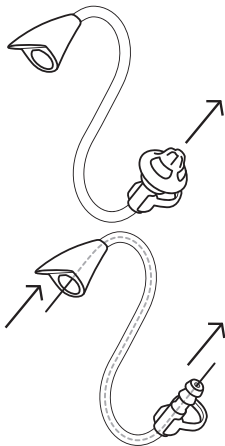

Carefully pull the ear-tip off the tube. If you have a custom ear-tip, you don't need to remove it to clean the tube.

Use a cleaning thread to clean the tube. Pass it through the tube. Pull the thread out at the other end. For further information on how to obtain cleaning threads, consult your hearing care professional. You can wash the instant ear-tip in lukewarm water **after having disconnected it from the rest of the ear-set**. Allow it to dry overnight.



Never use alcohol or other cleaning solutions to clean the ear-set, as this may cause discolouration.



## Changing the ear-tip

### Placing an instant ear-tip on the tube

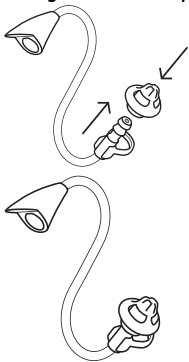

Gently insert the tube into the ear-tip until it reaches the end. It is very important to ensure that it is firmly attached.

### Placing a custom ear-tip on the tube



Hold the custom ear-tip and gently press the tube into place in the ear-tip, as illustrated. Use your fingernail to press the tube in as far as it will go.

## Changing the thin tube

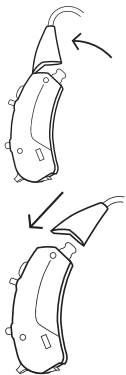

Lift the thin tube off the hearing aid in a slanting, backward movement, as shown

Click the thin tube onto the top of the hearing aid as illustrated.

## Using an anchor

The integrated anchor is not used with an instant double ear-tip solution and should be completely cut off.

If you are using an open ear-tip or a tulip ear-tip, you should trim the anchor to form an appropriately sized loop to ensure the comfortable retention of the ear-tip in the ear. To trim your anchor, do as follows:

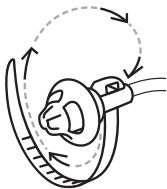
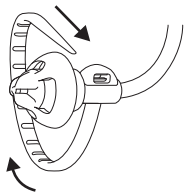

### **Example 1**

Pull the tip of the anchor through the small hole on the side of the tube.

When the loop is the correct size, cut off any excess with scissors or a similar implement.

### **Example 2**

Loop the anchor in the direction indicated by the dotted line and arrows.

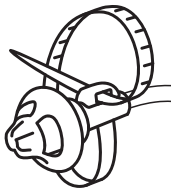

Guide the tip of the anchor through the small hole on the side of the tubing as illustrated to form a heart-shaped loop.



When the loop is the correct size, turn the ear-set around and cut off any excess with scissors or a similar implement.

The anchor loop is the correct size when it supports the position of the hearing aid in the ear, and when the ear-set sits securely in and on the ear.

**NOTE**

Make sure that the end of the anchor loop is flush with the small hole and that there are no sharp edges, as this may cause irritation in your ear. Use the tip of your finger to check for sharp edges.

**NOTE**

The integrated anchor is NOT used with a custom ear-set solution and should be completely cut off.

## CLASSIC EARMOULDS

This chapter describes how to clean and handle classic earmoulds for BTE models.

### Cleaning tools

You will receive the following cleaning tools with your hearing aid:

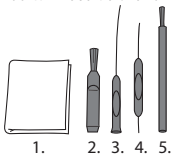

1. Cloth
2. Brush
3. Long wax-removing tool
4. Short wax-removing tool
5. Battery magnet

### Cleaning



Make sure that your ear-set is always clean and free of earwax and moisture. Wipe your ear-set with a cloth after use.

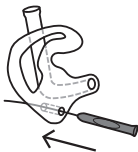

If you have a vent, clean it with the wax-removing tool.



Disconnect the tube with the earmould from the earhook of the hearing aid on a regular basis.



Rinse the tube and the earmould thoroughly in lukewarm water. Allow them to dry overnight.

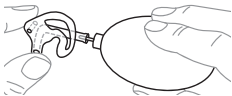

If there is moisture in the earmould or tube, use a blower or similar to blow them dry before attaching the tube to the ear-hook.



Never use alcohol or other cleaning solutions to clean the ear-set, as this may cause discolouration.

## **Changing the tube**

If your ear-set tubing breaks, you should replace it.

For further supplies of tubing, or if the earmould no longer fits your ear, contact your hearing care professional.



# SYMBOLS

Symbols commonly used by Widex A/S in medical device labelling (labels/IFU/etc.)

Symbol	Title/Description
--------	-------------------

**Manufacturer**

The product is produced by the manufacturer whose name and address are stated next to the symbol. If appropriate, the date of manufacture may also be stated.

---

**Catalogue number**

The product's catalogue (item) number.

---

**Consult instructions for use**

The user instructions contain important cautionary information (warnings/precautions) and must be read before using the product.

---

**Warning**

Text marked with a warning symbol must be read before using the product.

---

**WEEE mark**

“Not for general waste”. When a product is to be discarded, it must be sent to a designated collection point for recycling and recovering to prevent the risk of harm to the environment or human health as a result of the presence of hazardous substances.

---

<b>Symbol</b>	<b>Title/Description</b>
---------------	--------------------------

---



<b>CE mark</b>
----------------

The product is in conformity with the requirements set out in European CE marking directives.
---

---



<b>RCM mark</b>
-----------------

The product complies with electrical safety, EMC and radio spectrum regulatory requirements for products supplied to the Australian or New Zealand markets.
---

---



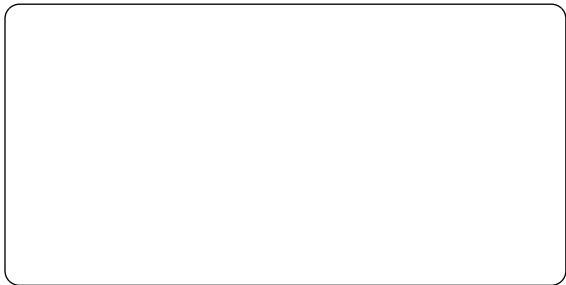

**WIDEX A/S**

Nymoellevej 6, DK-3540 Lyngby, Denmark  
<https://global.widex.com>

**Manual no.:**  
9 514 0561 001 #01  
**Issue:**  
2019-12

